

LED Ring Light

HDHRC-100S-UV-■ (Short (wide) type)

HDHRC-100L-UV-■ (Long (narrow) type)

* Only 24V USE

* Electric Power Consumption 21W

(Note) Please do not remove the tags attached to the product.
Light-emitting part during lighting, please do not look directly.

(注) 製品に取り付けられているタグは外さないでください

点灯中の発光部は、直視しないでください

Wave length
365
385
395
405

HR
HAYASHI-REPIC

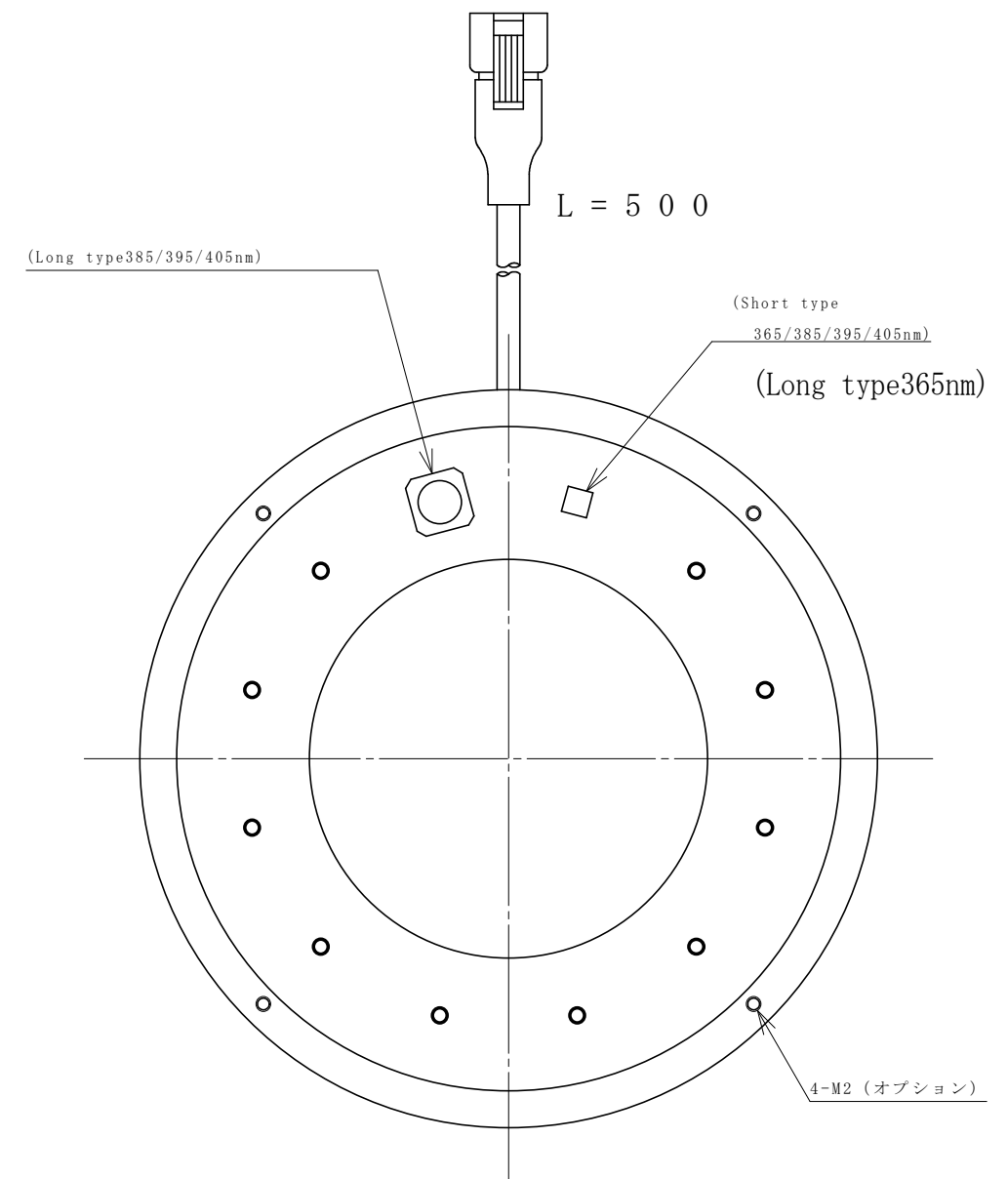
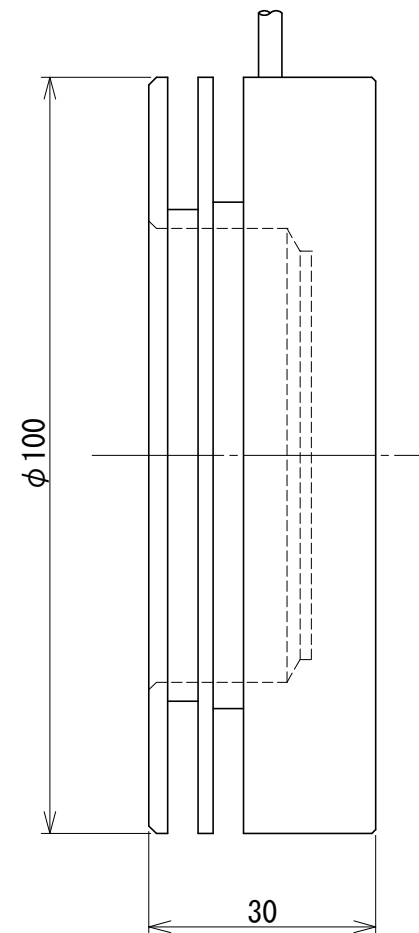
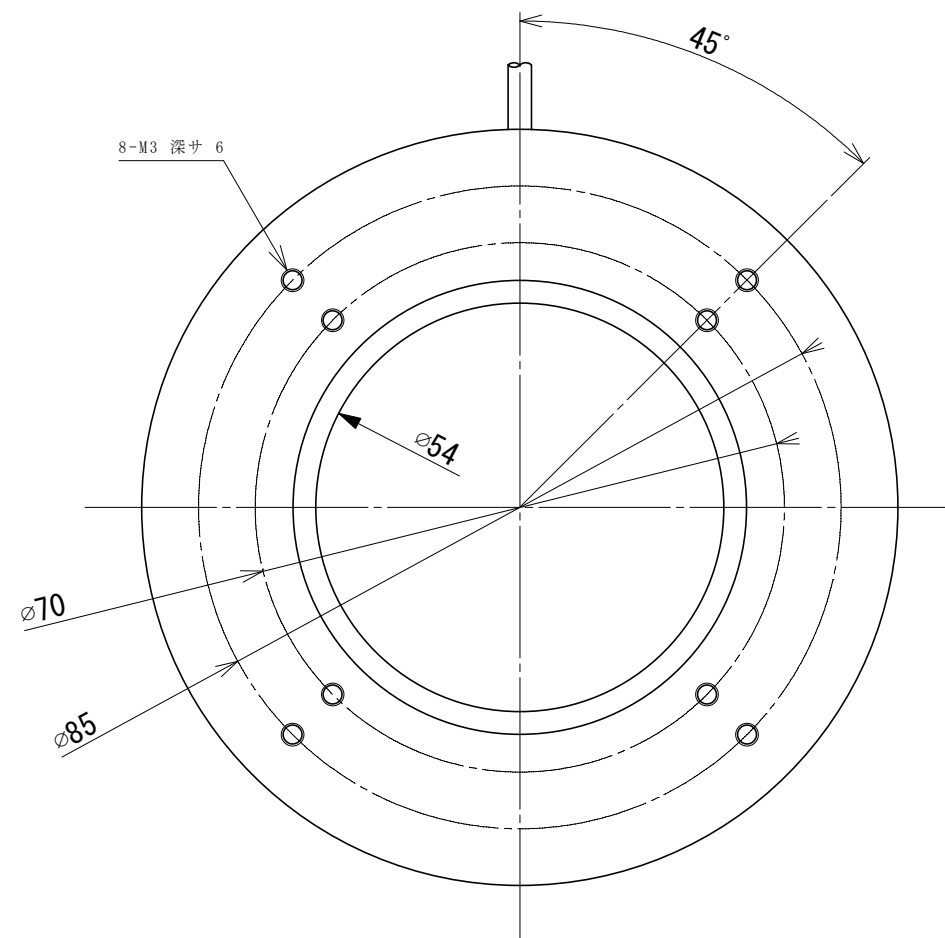

Details of Connector

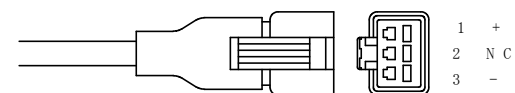

	Light	Power Supply
Connector	SMR-03V-B	SMP-03V-BC
Contact	BYM-001T-P0.6	BHF-001T-0.8SS